



WE TAKE CARE OF

# YOUR WASTE

FOOD WASTE • NEWSPAPERS • HOUSEHOLD WASTE

# How your rubbish gets new life

*Welcome to your new residence! In this district we have a new cutting edge automated vacuum waste collection system that recycles three types of waste – food, newspaper and household waste. That's why you have three separate waste inlets. If the recycling system is to work, it's important that you use the correct inlet for your waste.*

This brochure provides further information about how to sort your rubbish. Please contact us if you have any questions.

## GET STARTED WITH SORTING YOUR FOOD WASTE

Not sorted your food waste before? It's easy! But you need a few things to get started. When you moved in you will have been given a welcome package, including paper bags and a bag holder to keep in the kitchen. If you don't have these things, contact your landlord or housing association. This is also the point of contact when you need new bags.



### NO REFUSE LORRIES!

This is one of the advantages of an automated vacuum waste collection system, as you don't need refuse lorries to collect waste from each building.

### SAFER RESIDENTIAL ENVIRONMENT

Less heavy traffic and reduced noise.

### CLEANER CITY

Lower emissions of air pollutants and particles.







Did you know...

A biogas car can drive almost four kilometres on the biogas produced by one bag of food waste (approx. two kilos).

# FOOD WASTE

Place your food waste in the brown paper bags that you get from your landlord or housing association. Then dispose of the food waste bag in the brown waste inlet marked 'food waste'. Your food waste is then recycled and turned into biogas or biofertilizer, which contributes to a better environment.

## EXAMPLES OF FOOD WASTE

- Raw or cooked leftovers such as vegetables, fruit, fish, poultry, meat, eggs and flour
- Fruit and vegetable peelings
- Bread, biscuits, cakes and buns
- Chocolate and other sweets
- Coffee grounds, coffee filters and teabags
- Unbleached kitchen paper

Only use paper bags with an adhesive strip. They are completely biodegradable. Need more bags? Ask your landlord or housing association. Or have a look at [savab.se](http://savab.se) for information about where you can collect more paper bags.

Food waste inlet



The bag holder with air-holes helps keep the food waste bag dry, so it doesn't tear.







# NEWSPAPERS

Newspapers and paper are disposed of in the blue inlet marked 'newspapers'. If you have newspaper and advertising material with plastic wrapping, these should be removed and sorted as plastic packaging instead.

## EXAMPLES OF NEWSPAPERS AND PAPER

- Daily newspapers
- Magazines, mail order catalogues and travel brochures, advertising flyers, brochures
- Writing and drawing paper
- Paperbacks

Newspaper inlet

Did you know...

A single recycled newspaper saves enough energy to boil 38 cups of coffee. Paper fibres can be recycled up to seven times before they are worn out.







# HOUSEHOLD WASTE

Your 'ordinary rubbish bag' containing household waste is disposed of in the grey refuse inlet marked 'general waste'.

## EXAMPLES OF HOUSEHOLD WASTE

- Meat bones (*you can put fish and poultry bones in with your food waste*)
- Envelopes, letters and documents containing sensitive information
- Sanitary items such as nappies, sanitary napkins and cotton buds
- Vacuum cleaner bags and dust from sweeping
- Cigarette butts, ash and snuff
- Cat litter (including paper- and wood-based litter)
- Pot plants and cut flowers

### DON'T JAM THE SYSTEM!

Never dispose of bulky rubbish or large packaging such as pizza boxes, wine boxes or polystyrene in the refuse inlet. Even if you fold them, they can unfold and get stuck. Then the system will jam, and no-one will be able to dispose of their rubbish! Visit [www.savab.se](http://www.savab.se) for further info about where you can dispose of the above items.

If the system jams, contact your landlord or housing association.

General waste inlet



# HOW IT WORKS:

## WHERE YOUR RUBBISH GOES VIA OUR UNDERGROUND PIPELINES

### STEP 1

You dispose of your rubbish in the correct inlet. The waste is stored underneath each inlet for a few hours before it's time for emptying.



### STEP 4

At the terminal the waste is collected in separate containers – one for food waste, one for newspapers and one for general waste.



### STEP 3

The waste is sucked through long underground pipelines to the vacuum collection terminal.

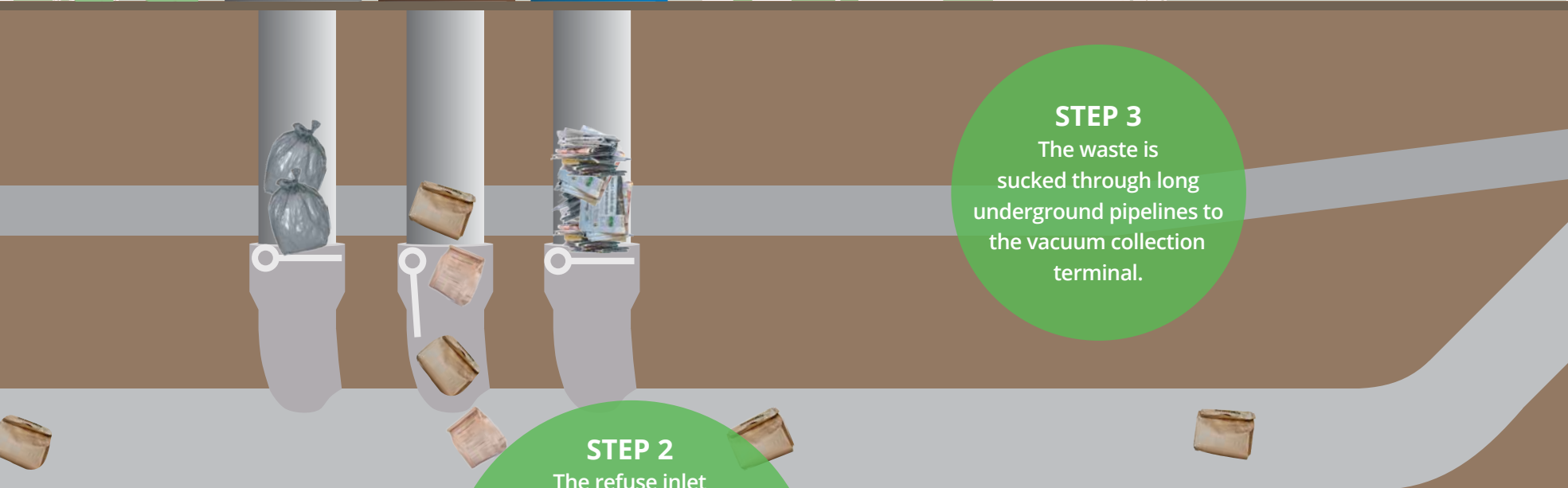

### STEP 2

The refuse inlet is emptied twice a day, separately for each type of waste. When it's time to empty the food waste, all food waste inlets are emptied simultaneously throughout the whole district.

### STEP 5

The containers are transported away for recycling. The food waste goes to a composting plant, where it is turned into biogas and biofertilizer. The newspaper goes to paper recycling and general waste to incinerators that generate district heating and electricity.

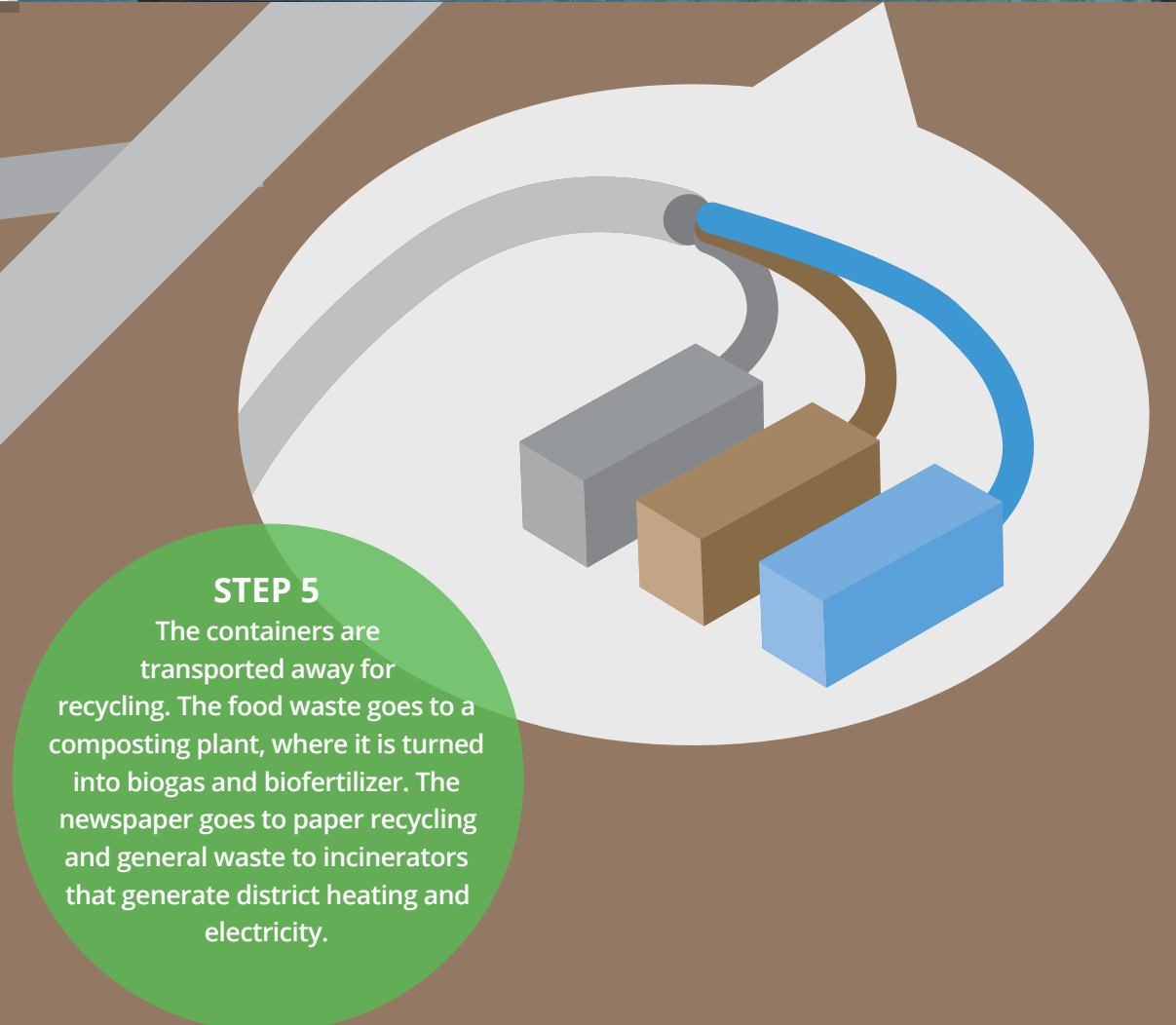



# Want to find out more?

[www.savab.se](http://www.savab.se)

Service centre  
**+46 (0)8-706 65 00**  
[info@savab.se](mailto:info@savab.se)

Online sorting guide  
[www.sorab.se/sorteringsguiden/](http://www.sorab.se/sorteringsguiden/)

Follow us on Facebook!  
[www.facebook.com/savab.se](http://www.facebook.com/savab.se)



**SUNDBYBERG**  
**AVFALL & VATTEN**